

Password managers

Last Modified on 03/29/2024 10:31 am EDT

Use a **password manager** to securely and efficiently access your accounts!

See also:

- [Password safety: Best practices](#)
- [Two-Factor: Get started with Duo](#)

What is it?

A **password manager** is a service or feature that **securely stores and autofills** your account credentials.

- **Automatically save** new accounts
- Generate **unique and complex** passwords
- **Securely store** other sensitive information

Is this what my browser does?

Isn't it bad to have all my passwords in one place?

How it works

1. Your sensitive information is stored in a **centralized vault**

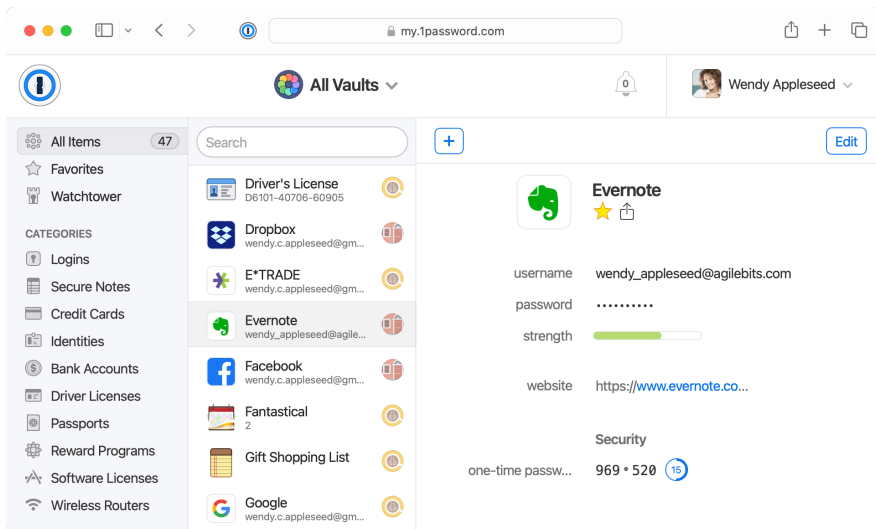

2. Accessed via **desktop application, browser extension, and/or mobile app**
3. The vault is **unlocked with a master password**

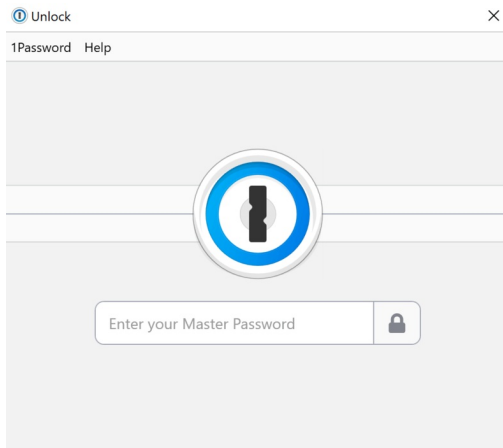

4. Logging into a **new website automatically stores the credentials**

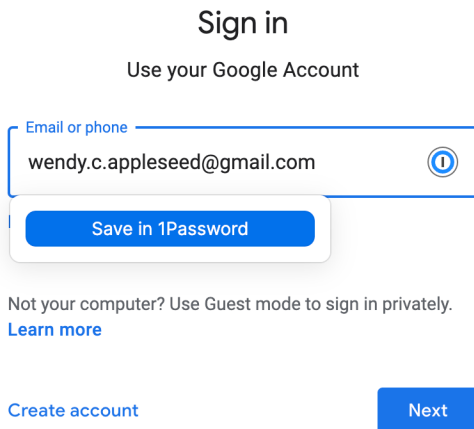

5. Stored credentials **autofill** when visiting that site

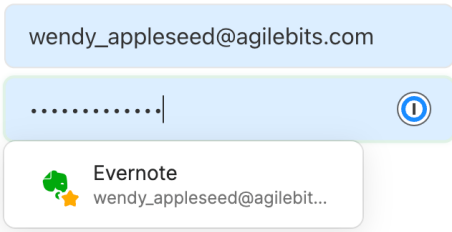

Popular options

Read more: The best password managers according to [NY Times](#) and [CNET](#).



1Password



Bitwarden



Dashlane

Questions?

If you have any additional questions or problems, don't hesitate to reach out to the **Help Desk!**

Phone: 610-526-7440 | [Library and Help Desk hours](#)

Email: help@brynmawr.edu | [Service catalog](#)

Location: Canaday Library 1st floor